

# C-One<sup>2</sup>

## Quick Start and Regulatory Guide

QSG 180190 A20



| Non-Contractual Pictures |

Les Fontaines de la Duranne  
185 avenue Archimède 13857 Aix-en-Provence FRANCE  
T. +33 (0)4 42 65 25 65 F. +33 (0)4 42 51 57 32

**coppernic.fr**

SAS AU CAPITAL DE 100 000 EUROS • RCS : AIX 509 059 572  
SIRET : 509 059 572 00016 • APE 6201Z • TVA : FR 58 509 059 572

# C-One<sup>2</sup>

## Quick Start and Regulatory Guide

QSG 180190 A20

### WHAT'S IN THE BOX ?

C-One<sup>2</sup> HF ASK

C-One<sup>2</sup> HF iClass | LF Prox

C-One<sup>2</sup> HF LEGIC | LF TM

C-One<sup>2</sup> LF Agrident



1 DEVICE

2 NOTICE

3 BOX

4 HANDSTRAP

5 CABLE MICRO USB | USB A

6 STYLUS

7 PLUG | EUROPE

8 POWER SUPPLY

9 TEST REPORT

# C-One<sup>2</sup>

## Quick Start and Regulatory Guide

QSG 180190 A20

### PRODUCT OVERVIEW

C-One<sup>2</sup> HF ASK

C-One<sup>2</sup> HF iClass | LF Prox

C-One<sup>2</sup> HF LEGIC | LF TM



C-One<sup>2</sup> LF Agrident



coppennic.fr

SAS AU CAPITAL DE 100 000 EUROS • RCS : AIX 509 059 572  
SIRET : 509 059 572 00016 • APE 6201Z • TVA : FR 58 509 059 572

| Non-Contractual Pictures |

## Setting up your device

### CAUTION

Failure to completely reseal the Micro SD | Micro SIM card slot cover may lead to water or other liquids entering the casing which may cause damage to the device.

### MICRO SIM card installation

- Open Micro SD | Micro SIM door.
- To remove the Micro SIM card: Insert a removal tool (pin type) into the hole then push until the tray pops out.
- Put the Micro SIM card on the tray.
- Insert Micro SIM tray into SIM slot.
- Close the door after installation.



### MICRO SD card installation

- Open Micro SD | Micro SIM door.
- Insert Micro SD card into Micro SD card slot.
- Close the door after installation.

### NOTE

Micro SIM card and Micro SD card should be purchased separately.

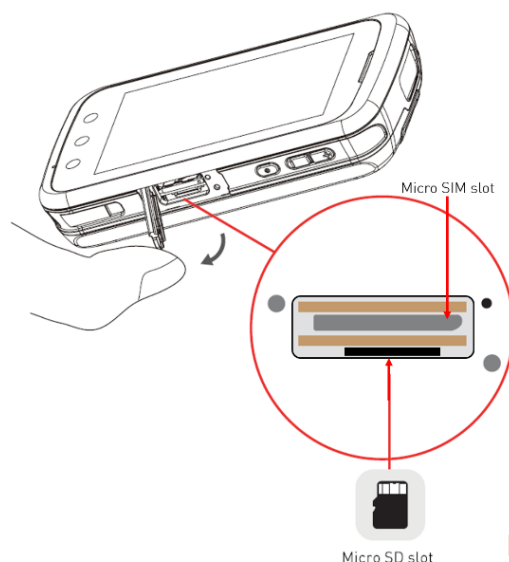

### Setting up your device

#### CAUTION

Do not use internal peripherals during charging process.

Please make sure the device being charged fully when using C-One<sup>2</sup> at first time.

Please ensure the Micro USB port clean and dry before inserting a USB cable for charging to avoid the operating issues on the device.

Please remove water or moisture from the Micro USB port instantly with soft cloth when the device gets wet, to avoid the operating issues on the device.

#### Charge the BATTERY

Before using the C-One<sup>2</sup> charge the battery using one of the following accessories approved by COPPERNIC:

1. **Insert the micro USB cable into the C-One<sup>2</sup> and USB A c**
  - > Cable Micro USB | USB A is included in the device box.
  - > Power supply is included in the device box.

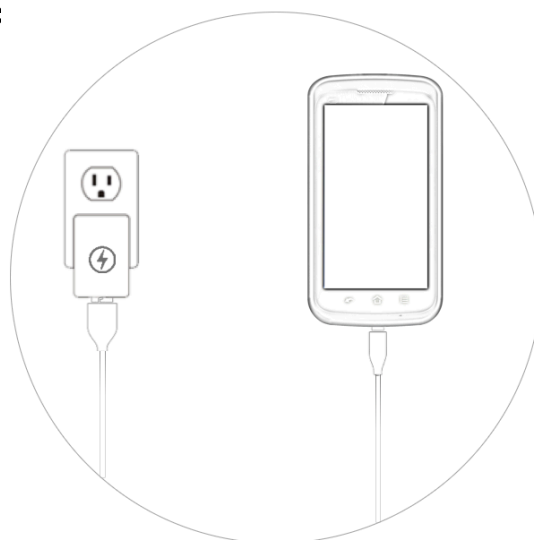



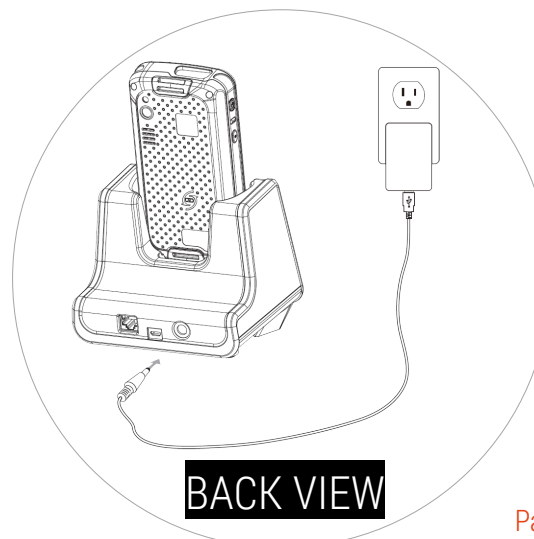

2. **Insert the Jack Power Adapter into the docking station and the USB A cable into the power supply.**
  - > Cable USB A | Jack Power Adapter is included in the docking station box.
  - > Power supply is included in the docking station box.

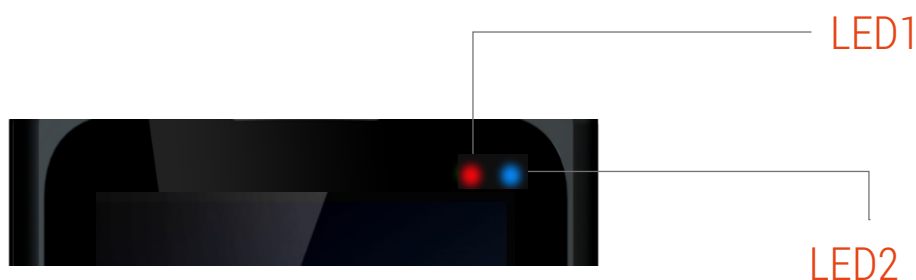

## Setting up your device

### LED indicators



	Red LED blinks (LED1)	Low battery
	Red LED (LED1)	Battery is charging
	Green LED (LED1)	Battery is fully charged
	Blue LED blinks (LED2)	BT devices connected or receiving messages/notifications

### Using your device

#### TURNING ON | TURNING OFF your device

**Power Off** | Press and hold during 5 sec. the power button and select "Power off" in the dialog box.

**Reboot** | Press and hold during 5 sec. the power button and select "Reboot" in the dialog window to restart the device.

**Suspend Mode** | Press and release the power button to place the device in suspend mode. The display will be off and go into a low power state to conserve battery power.

**Reset** | Press and hold the power button during 30s.



### Using your device

#### DATA CAPTURE | photos & videos

Use the rear camera to take photos and capture video.

1. Go to Home Screen > select **"Camera"** > Tap camera icon or screen to take a picture/switch to video icon and tap for video recording.
2. Using the rear camera to take photos and capture video.

#### NOTE

Ensure device memory or extend Micro SD card space is available.

#### DATA CAPTURE | barcode scanner

#### CAUTION



Class 2 laser when open.

Do not stare into beam or view with optical instruments.

Complies with 21cfr1040.10 and 1040.11 except for deviations pursuant to laser notice no. 50, dated June 24, 2007 and IEC/EN 60825-1:2014.

#### NOTE

Please remove the protector film before using scanner.

#### Scan with the imager

- Use **"barcode manager"** provided by Copernic.

#### Side-Key Remapping for scanning

- Go to **"Settings"** > Select **"Remap key & Shortcut"**
- Select the key (P1, P2 : blue side keys) > Tap Remap Key > Tap Barcode Scan
- The red laser aiming pattern turn on to assist in aiming, scan ready when beep sounds
- Release the scan button.





### Using your device

#### RFID

C-One<sup>2</sup> HF ASK - C-One<sup>2</sup> HF iClass | LF Prox - C-One<sup>2</sup> HF LEGIC | LF TM with RFID options to read, please put the TAG/CARD on the RFID area.



C-One<sup>2</sup> LF AGRIDENT with RFID options to read, please put the TAG/CARD on the RFID area.



## Regulatory information

### CAUTION

Only use COPPERNIC approved accessories.

### Operating frequencies C-One<sup>2</sup>

EUT Type	Handheld Device
Brand Name	COPPERNIC
Model Name	C-ONE <sup>2</sup> /C-ONE <sup>2</sup> (WOS)
Tx Frequency Bands (Unit: MHz)	GSM 900 : 880 ~ 915
	GSM 1800 : 1710 ~ 1785
	WCDMA Band I : 1920 ~ 1980
	WCDMA Band VIII : 880 ~ 915
	LTE Band 1 : 1920 ~ 1980
	LTE Band 3 : 1710 ~ 1785
	LTE Band 7 : 2500 ~ 2570
	LTE Band 8 : 880 ~ 915
	LTE Band 20 : 832 ~ 862
	LTE Band 28 : 703 ~ 748
	WLAN : 2412 ~ 2472, 5180 ~ 5320, 5500 ~ 5700
	Bluetooth : 2402 ~ 2480
	RFID option HF ASK: 13.56MHz
	RFID option LF AGRIDENT: 134.2KHz
Maximum AVG Conducted Power (Unit: dBm)	RFID option HF iClass : 13.56 MHz
	RFID option LF Prox : 125KHz
	RFID option HF LEGIC : 13.56 MHz
	RFID option LF TM : 125KHz
	GPS : 1575.42
	GSM 900 : 33.78
	GSM 1800 : 31.12
	WCDMA Band I : 23.68
	WCDMA Band VIII : 23.77
	LTE Band 1 : 24.52
	LTE Band 3 : 23.98
	LTE Band 7 : 23.97
	LTE Band 8 : 23.99
	LTE Band 20 : 23.99
	LTE Band 28 : 23.94
	802.11b : 15.83
	802.11g : 16.72
	802.11n HT20 (2.4GHz) : 16.76
	802.11n HT40 (2.4GHz) : 15.83
	802.11a : 15.13
	802.11n HT20 (5GHz) : 15.17
	802.11n HT40 (5GHz) : 15.30
	802.11ac VHT80 : 14.82
	Bluetooth : 2.36

**NOTE : C-One<sup>2</sup> : Maximum reported SAR value (10g) Body: 1.71W/kg @5mm**

## Wireless Device Country Approval

### CAUTION

Operation of the device without regulatory approval is illegal.

Regulatory markings, subject to certification, are applied to the device signifying the radio(s) are approved for use in the European countries under CE coverage.

For 2.4GHz or 5GHz products : Europe includes Austria, Belgium, Bulgaria, Czech Republic, Cyprus, Denmark, Estonia, Finland, France, Germany, Greece, Hungary, Iceland, Ireland, Italy, Latvia, Liechtenstein, Lithuania, Luxembourg, Malta, Netherland, Norway, Poland, Portugal, Romania, Slovak Republic, Slovenia, Spain, Sweden, Switzerland and the United Kingdom.

## Country Roaming

This device incorporates the international roaming feature which will ensure the product operates on the correct channels for the particular country of use.

## Ad-Hoc Operation (5GHz Band)

Ad-Hoc operation is limited to Channels 36- 48 (5150 – 5250 MHz). Use of this band is restricted to indoor use only, any other use will make the operation of this device illegal.

## Warnings of Use Wireless Devices

Please observe warning notices with regard to the usage of wireless devices.

### Potentially Hazardous Atmospheres – Vehicles Use

You are reminded of the need to observe restrictions on the use of radio devices in fuel depots, chemical plants etc. and areas where the air contains chemicals or particles (such as grain, dust, or metal powders) and any other area where you would normally be advised to turn off your vehicle engine.

### Safety in Aircraft

Turn off your wireless device whenever you are instructed to do so by airport or airline staff.

### Safety in Hospitals

Wireless devices transmit radio frequency energy and may affect medical electrical equipment. Wireless devices should be switched off whenever you are requested to do so in hospitals, clinics or healthcare facilities. These requests are designed to prevent possible interference with sensitive medical equipment.

## Safety Information – Europe

This device was tested for typical body-worn operation. Use only COPPERNIC tested and approved accessories to ensure EU compliance.

## Laser Devices

Class 2 laser scanners use a lower power, visible light diode. As with any very bright light source, such as the sun, the user should avoid staring directly into the light beam. Momentary exposure to a class 2 laser is not known to be harmful.

### CAUTION

Use of controls, adjustments or performance of procedures other than those specified herein may result in hazardous laser light exposure.

## Power Adaptor

Use only a C-One<sup>2</sup> approved Power Adaptor with electrical ratings: Output 5VDC, min 2A, with a maximum ambient temperature of at least 45°C. Use of alternative power adaptor will invalidate any approvals given to this device and maybe dangerous.

## Battery Information

Use only a COPPERNIC approved batteries.

When devices are stored over six (6) months without use, some irreversible deterioration in overall battery quality may occur. Store devices at half of full charge in a dry, cool place. When storing devices for one year or longer, the charge level of battery should be verified at least once a year and charged to half of full charge.

## Battery Safety

1. The area in which the units are charged should be clear of debris and combustible materials or chemicals. Particular care should be taken where the device is charged in a non-commercial environment.
2. Follow battery usage, storage, and charging guidelines found in the user guide.
3. Improper battery use may result in a fire, explosion, or other hazard.
4. To charge the device battery, the battery and charger temperature must be between 0°C~+45°C.
5. Do not use incompatible batteries and chargers. Use of an incompatible battery or charger may present a risk of fire, explosion, leakage, or the hazard.
6. Do not disassemble or open, crush, bend or deform, puncture, or shred the device.
7. Severe impact from dropping any battery-operated device on a hard surface could cause the battery to overheat.
8. Do not short circuit a battery or allow metallic or conductive objects to contact the battery terminals.
9. Do not modify or remanufacture, attempt to insert foreign objects into the battery, immerse or expose to water or other liquids, or expose to fire, explosion, or other hazard.
10. Do not leave or store the equipment in or near areas that might get very hot, such as in a parked vehicle or near a radiator or other heat source. Do not place battery into a microwave oven or dryer.
11. Battery usage by children should be supervised.
12. Please follow local regulations to promptly dispose of used re-chargeable batteries.
13. Do not dispose of batteries in fire.
14. Seek medical advice immediately if a battery has been swallowed. In the event of a battery leak, do not allow the liquid to come in contact with the skin or eyes. If contact has been made, wash the affected area with large amounts of water and seek medical advice.

## Frequency of WLAN Operation

The device is restricted to indoor use only when operating in the 5180 to 5240 MHz frequency range.

This device complies with **Directive 2014/53/EU** issued by the Commission of the European Community.

	AT	BE	BG	HR	CY	CZ	DK
	EE	FI	FR	DE	EL	HU	IE
	IT	LV	LT	LU	MT	NL	PL
	PT	RO	SK	SI	ES	SE	UK

Copyright© 2020 COPPERNIC. All rights reserved.